

(50-43)

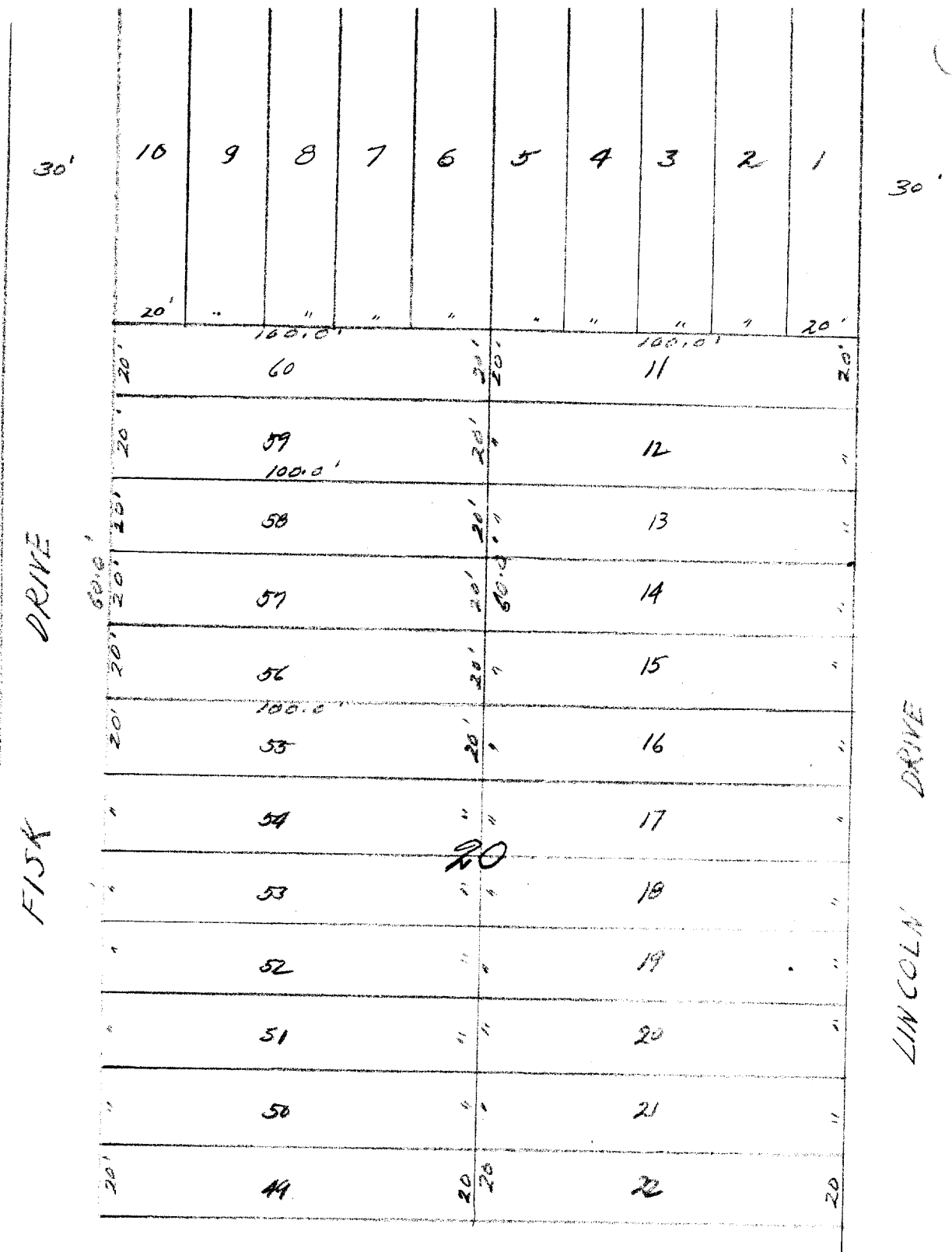

DESCRIPTION:

Lots 56, 57, and 58, Block 20, Lake Ivanhoe Resort Subdivision, of a portion of Section 34, Town 2 north, Range 18 east of the 4th P.M., and parts of Sections 2 and 3, Town 1 north, Range 18 east of the 4th P.M.

CERTIFICATE:

I, hereby certify that I have on this the 7th day of April 1950, surveyed the above described property according to the official records on file in the office of the Recorder of Deeds in and for Walworth County, Wisconsin, and find that the measurements and bearings of the boundary lines of said property as taken at the site on this day, substantially agree with those in said official plat, and that no encroachments exist.
SIGNED AND SEALED ON THIS 8TH DAY OF APRIL 1950.

Joseph M. Blagi
Joseph M. Blagi, Professional Engineer
Elkhorn Wisconsin.